

**Design Data**

Medium	Beer
Design pressure MPa	0.2
Operating pressure MPa	0.15
Design temperature °C	90
Operating temperature °C	80
Corrosion allowance mm	0
Weld joint factor	0.85
Material	SUS304
Capacity(Nominal/working)	1050L(7BBL)

**Specification**

Item	Spec	Connecting	Name
a	Ø38	Tri-Clamp	outlet
b	Ø38	Tri-Clamp	spare hole
c	Ø38	Tri-Clamp	thermometer hole
d	Ø38	Tri-Clamp	sample hole
e	Ø400*300	quick-opened	shadowless manway
f	Ø38	Tri-Clamp	cleaning hole
g	Ø38	Tri-Clamp	spare hole
h	Ø38	Tri-Clamp	pressure gauge port
j	Ø38	Tri-Clamp	spare hole
k	Ø38	Tri-Clamp	Carbonation point
l1-2	Ø38	quick-installed	sight level tube port

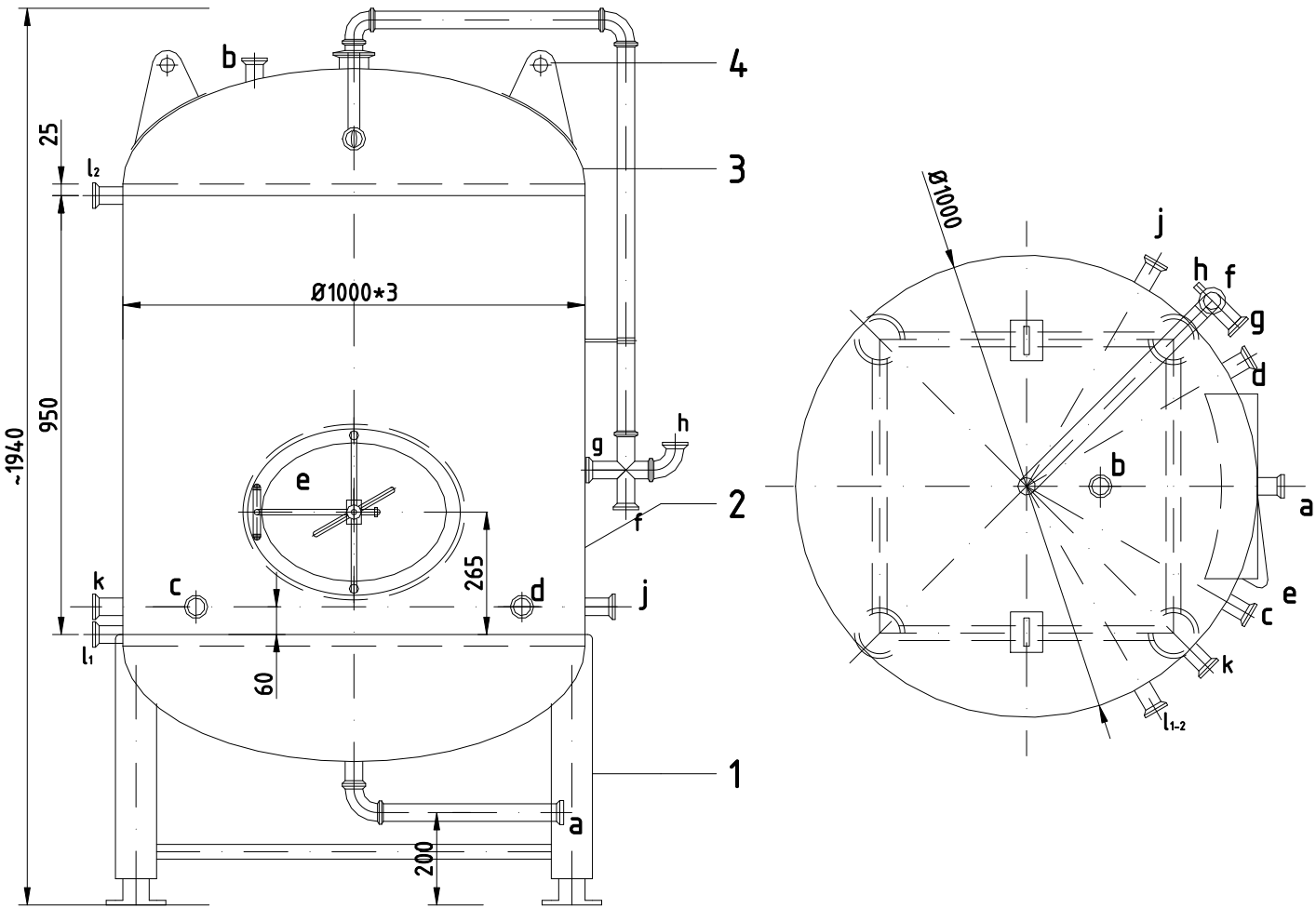

**Technical parameters**

- 1.The inner surface polished to  $Ra \leq 0.22 \mu m$ .
- 2.Outer surface adapts high accuracy Polishing.
- 3.Nozzle position by vertical view.
- 4.To filled with water in tank for leak testing.

4		lifting ears	2	SUS304	
3		dish head	1	SUS304	
2		inner tank	1	SUS304	
1		legs	4	SUS304	
No.	Drawing id./standard	Description	Qty.	Material	

**Wenzhou Shuangding Machinery Co., Ltd**

responsibility	Sign	Date	Bright beer tank	
Designed			7BBL	
Checked			Scale	1:15
Reviewed				